



- Calibration for Either Magnetic or Non-Magnetic Panel Mounting
- $\pm 2\%$ F.S. Accuracy ($\pm 3\%$ F.S. for Compensated Type)
- Compensated Wattmeters for Low Value Power Measurement
- Wide Angle Visibility
- Two Popular Sizes: 2-1/2", 3-1/2"
- Phenolic Cases With Glass Windows



Model Number	Size	Meter Movement
175	2-1/2"	Dynamometer
75	3-1/2"	Dynamometer

For industrial or commercial applications, the Round style, single phase wattmeter offers maximum reliability and $\pm 2\%$ of full scale (F.S.) accuracy ($\pm 3\%$ F.S. for Compensated type). With a black phenolic case and glass window for optimum viewing, the Round style meter is a popular replacement. Two popular sizes of 2-1/2" and 3-1/2" (3-1/2" size only for Compensated type) are available to measure from 20 watts to 3000 watts. Due to power dissipation, errors are usually prevalent in standard wattmeters at low values of power. This error is corrected in Simpson's Compensated Wattmeters. The Simpson dynamometer movement is cali-

brated for either magnetic or non-magnetic panels and for a frequency range of 25-125 Hz. The dynamometer movement is air-damped, utilizing the same high quality pivots and jewels as the other fine Simpson meters to support the moving element. This style of meter is ideal for many other electrical functions. See the "Function Reference Table."

Dimensions and Compatibility

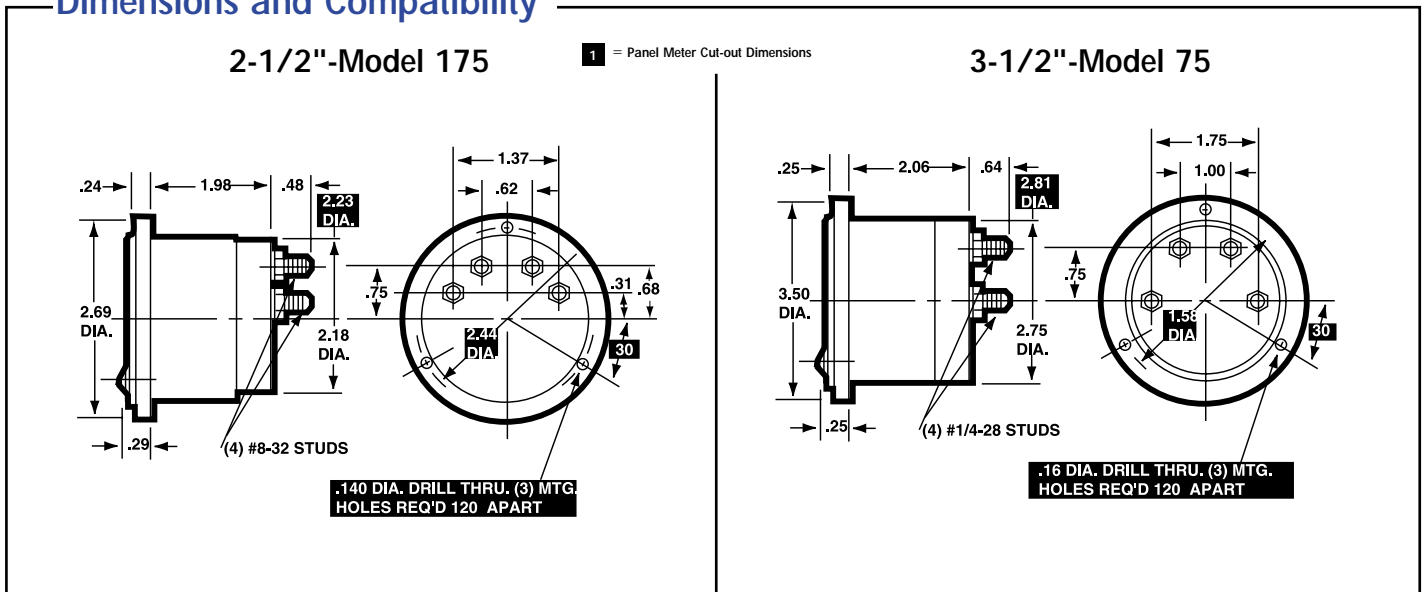

Compatibility Reference Table

Manufacturer	Size/Model
	3 1/2"
Crompton Fiesta	Model 016

