

C&K CM Series Single Pole Power Rocker Switches

Features/Benefits

- Illuminated versions available
- Easy to install snap-in design
- Multiple actuator and termination styles to choose from

Typical Applications

- Computers and peripherals
- Power supplies
- Industrial equipment
- Small appliances

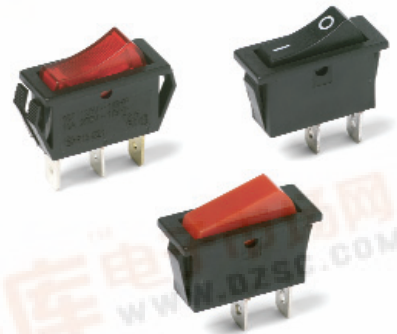

Specifications

CONTACT RATING:

UL/CSA: 16 AMPS @ 125 VAC, 1/8 HP;
10 AMPS @ 250 VAC, 1/3 HP.

ELECTRICAL LIFE: 10,000 make and break cycles at full load.

INSULATION RESISTANCE: $10^8 \Omega$ min.

DIELECTRIC STRENGTH: 1,500 VRMS @ sea level.

Materials

HOUSING AND ACTUATOR: 6/6 nylon (UL94V-2), black, gloss or matte finish.

ILLUMINATED ACTUATOR: Polycarbonate, gloss or matte finish.

CENTER CONTACTS: Silver plated, copper alloy.

END CONTACTS: Silver plated.

ALL TERMINALS: Silver plated, copper alloy.

NOTE: Specifications and materials listed above are for switches with standard options. For information on specific and custom switches, consult Customer Service Center.

Build-A-Switch









To order, simply select desired option from each category and place in the appropriate box. Available options are shown and described on pages 20 thru 22. For additional options not shown in catalog, consult Customer Service Center.

Switch Function	Actuator	Actuator Color	Mounting Style/Color	Termination	Actuator Marking	Contact Rating	Lamp Rating
CM101 SPDT On-None-On CM102 SPST On-None-Off CM103 SPDT On-Off-On CM107 SPDT On-Off-Mom. CM12 * SPST On-None-Off	J1 Rocker J3 Illuminated rocker J6 Rocker J8 Illuminated rocker	2 (STD.) Black 1 White 3 Red R Red, illuminated A Amber, illuminated G Green, illuminated	S2 (STD.) Snap-in, black S4 (STD.) Snap-in, black S1 Snap-in, white S3 Snap-in, white	05 (STD.) .250" quick connect 07 Solder lug	(NONE) (STD.) No marking D ON-OFF H "O I" - international ON-OFF P "O -" international ON-OFF	QA (STD.) Silver	(NONE) (STD.) No lamp 7 125 VAC neon 8 250 VAC neon

* CM12 - for switches with both marking and illumination

C&K CM Series Single Pole Power Rocker Switches

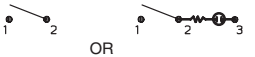
SWITCH FUNCTION

NO. POLES	MODEL NO.	SWITCH FUNCTION			CONNECTED TERMINALS			SCHEMATIC	
									
		C&K marking on opposite side			C&K marking on opposite side				
SP	CM101	ON	NONE	ON	2-3	N/A	2-1		
	CM102	ON	NONE	OFF		 OR For Illuminated Version			
	CM103	ON	OFF	ON		OPEN			
	CM107	ON	OFF	MOM.					
	CM12 *	ON	NONE	OFF					

* CM12 - for switches with both marking and illumination

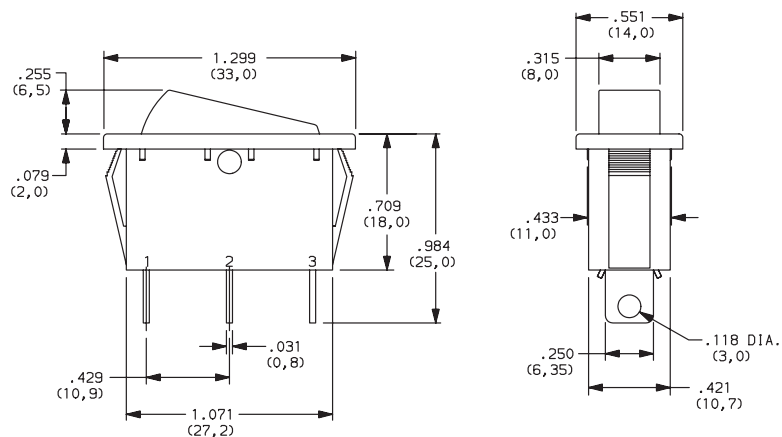

ACTUATOR

J1 ROCKER
J3 ILLUMINATED ROCKER

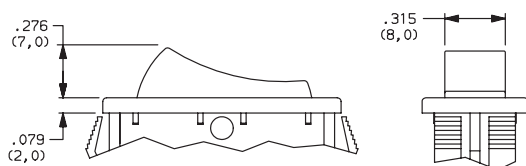

NOTE: J3 actuator available with CM102 switch function only.

J6 ROCKER
J8 ILLUMINATED ROCKER

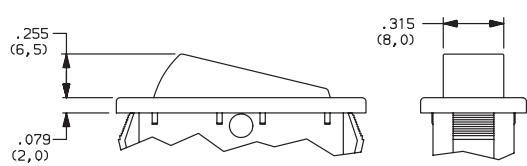

NOTE: J8 actuator available with CM102 switch function only.

C&K CM Series

Single Pole Power Rocker Switches

ACTUATOR COLOR

OPTION CODE	ACTUATOR COLOR
2	(STD.) BLACK
1	WHITE
3	RED
R	RED, ILLUMINATED
A	AMBER, ILLUMINATED
G	GREEN, ILLUMINATED

MOUNTING STYLE/COLOR

S2 (STD.) SNAP-IN, BLACK

S1 SNAP-IN, WHITE

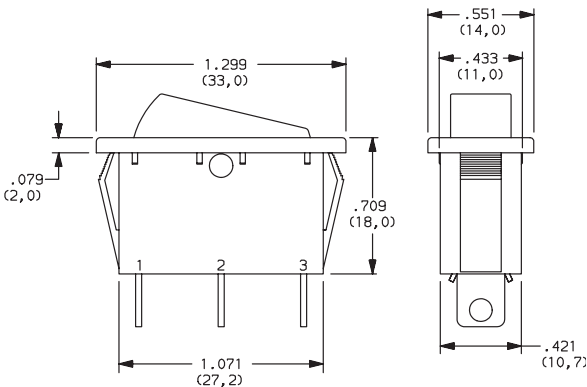

S4 (STD.) SNAP-IN, BLACK (SHORT FRAME)

S3 SNAP-IN, WHITE

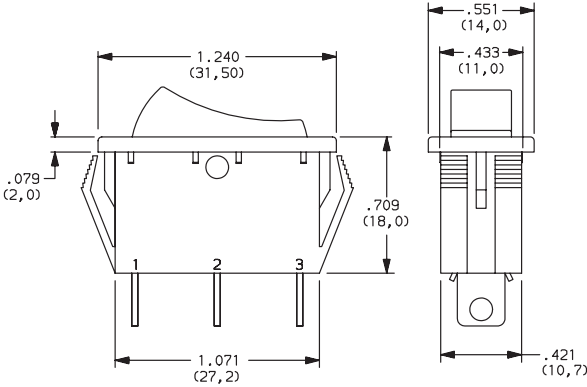

PANEL

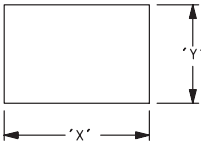

PANEL THICKNESS	"X"	"Y"
0.030-0.049 (0,75-1,25)	1.189-.004 (30,2-0,1)	0.441+.004 (11,2+0,1)
0.049-0.079 (1,25-2,0)	1.197-.004 (30,4-0,1)	0.441+.004 (11,2+0,1)
0.079-0.118 (2,0-3,0)	1.212-.004 (30,8-0,1)	0.441+.004 (11,2+0,1)

TERMINATION

05 (STD.) .250" QUICK CONNECT

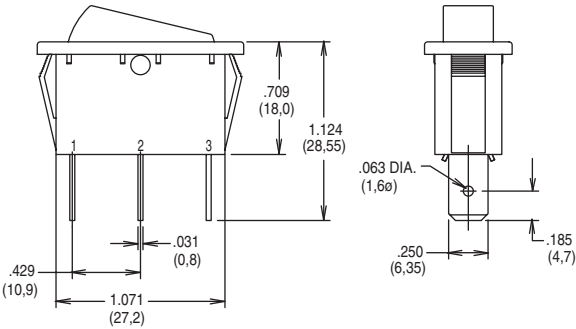

07 SOLDER LUG

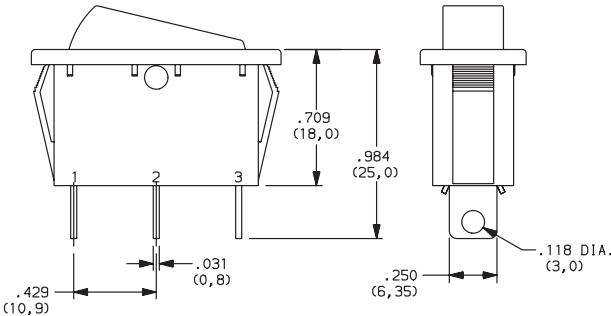

NOTE: Available with CM101 & CM102 switch functions only.

C&K CM Series Single Pole Power Rocker Switches

ACTUATOR MARKING

NONE (STD.) NO MARKING



D ON-OFF



H O I

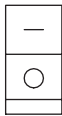

P O -

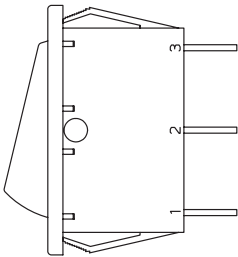

NOTE: Orientation of actuator marking and terminals.

CONTACT MATERIAL

OPTION CODE	CONTACT AND TERMINAL MATERIAL	RATINGS	
		POWER	
QA (STD.)	SILVER		16 AMPS @ 125 VAC; 1/8 HP 10 AMPS @ 250 VAC, 1/3 HP (UL/CSA).

LAMP RATING

(NONE) NO LAMP

7 125 VAC 33kΩ NEON

8 250 VAC 150kΩ NEON

NOTE: Lamp rating for J3 & J8 actuator option.