



OXFORD ELECTRICAL PRODUCTS

low profile line isolation transformers

0800 316 6060

[get an online quote](#)

[get a catalogue delivered](#)

[download entire catalogue](#)

[can't find what your looking for ??..](#)

[back to catalogue index](#)

[home](#)

Type OEP 1200 1:1 600 Ohm



Provides isolation between modems or similar devices and telephone lines. This transformer is designed for use in voice or data transmission circuits where the line d.c. is diverted from the windings by a choke or solid state device. The use of this transformer should enable the equipment it is used with to comply with the relevant requirements of BS6305.

Resin encapsulated in flame retardant cases. The unit is PCB Mounting

Insertion loss	1.5dB max @ 2kHz.
Return loss	-20dB @ 200Hz-4kHz.
Isolation longitudinal	3.54kV RMS or 5kV dc.
Saturation	10V RMS 65V peak.
Balance	Better than 80dB 200Hz-4kHz.
Signal/noise ratio	> 33dB
dc resistance	68 Ω \pm 10% (NB. not to be tested with a dc current)

TEST CIRCUIT

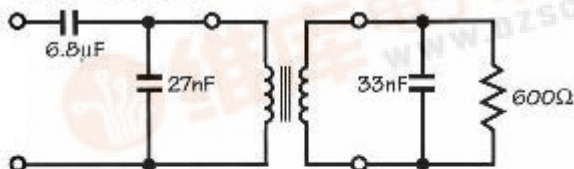

DIMENSIONS H = 12.5 W = 18 D = 18

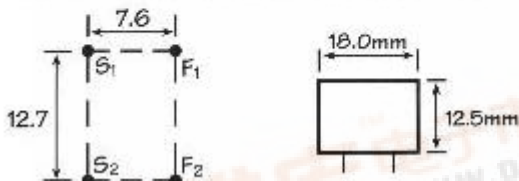

Approved to EN60950
and EN41003
BAPT Certificate of
Recognition CR/0126



Type Z1260 1:1 600 Ohm



Provides isolation between modems or similar devices and telephone lines. This transformer is designed for use in voice or data transmission circuits where the line d.c. is diverted from the windings by a choke or solid state device. The use of this transformer should enable the equipment it is used with to comply with the relevant requirements of BS6305. This is a lower profile version of the OEP 1200 transformer.

Resin encapsulated in flame retardant cases. The unit is PCB Mounting

Insertion loss	1.5dB max @ 2kHz.
Return loss	-20dB @ 200Hz-4kHz.
Isolation longitudinal	3.5kV RMS or 5kV dc.
Saturation	< 10V RMS 65V peak.
Balance	Better than 80dB 200Hz-4kHz.
Signal/noise ratio	> 33dB
dc resistance	68 Ω \pm 10% (NB. not to be tested with a dc current)

DIMENSIONS

Height 11mm
Width 15mm
Length 19mm

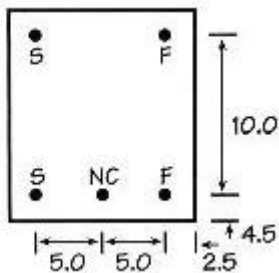

**Approved to EN60950 and
EN41003
BABT Certificate of
Recognition CR/0126**

