

PART NUMBER: 334HC2800K2CM6

Conduction Cooled (High Density Resonant)
Parts are RoHS compliant

ELECTRICAL SPECIFICATIONS

Capacitance: 0.33 uF
AC Current: 300 A
ESR: 0.8 milliOhms at 100 kHz and 20°C
Self Inductance: 3 Nanohenries maximum

Tolerance: -10 % , +10 %
Temperature Range: -40°C to +85°C
Maximum Core Temperature: 85°C
Resonant Frequency: 150-216 kHz
Maximum power (KVAR): 200
VAC: 800 Volts AC

PHYSICAL DIMENSIONS

Length (L): 68 mm, 0.5 mm
Height (H): 30 mm, +/-0.5 mm
Thickness (B): 30.2 mm, +/-0.1 mm

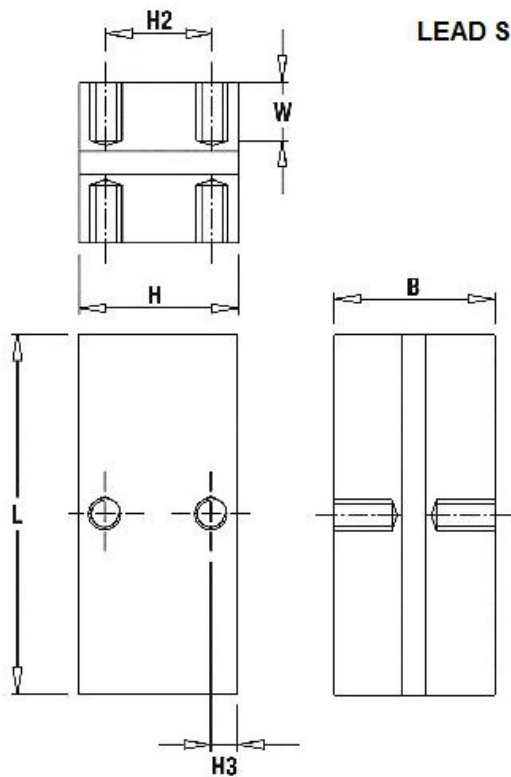

LEAD STYLE: 2CM6

L	H	B	W	H2	H3
68 \pm 0.5	30 \pm 0.5	30.2 \pm 0.1	10	20	5
Mounting holes: M6x1 tap filled with SS helicoil					
Tightening torque: 15Nm MAX					