

## IEC Appliance Connector C14 with Fuseholder 2-pole

Plug removal necessary for fuse replacement



70° C



70° C

**Description**

- Panel Mount:  
Screw-on from front side
- 2 Functions:  
Inlet protection class I or II, Fuseholder for fuse-links 5 x 20 mm, 1- or 2-pole
- Quick connect terminals 4.8 x 0.8 mm
- We recommend for new applications the new type [4707](#)

**Characteristics**

- All single elements are already wired
- With slotted screw type fuseholder  
Fuse drawer meets requirements of medical standard IEC/EN 60601-1  
The fuse drawer can only be opened with the aid of a tool  
The fuseholder is accessible from the equipment front
- Qualified for use in equipment according IEC/EN 60950

**Weblinks**

[Approvals](#), [RoHS](#), [CHINA-RoHS](#), [e-Store](#), [SCHURTER-Stock-Check](#), [Distributor-Stock-Check](#)

**Technical Data**

Ratings IEC	10 A / 250 VAC; Hz 50
Ratings UL/CSA	6 A / 250 VAC; 60 Hz
Dielectric Strength	> 2 kVAC between L-N > 4 kVAC between L/N-PE (1 min/50 Hz)
Allowable Operation Temp.	-25 °C to 70 °C
Degree of Protection	from front side IP 40 acc. to IEC 60529
Protection Class	Suitable for appliances with protection class I or II acc. to IEC 61140
Terminal	Quick connect terminals 4.8 x 0.8 mm
Panel Thickness s	Screw-on: max 6 mm Mounting screw torque max 0.5 Nm
Material: Housing	Thermoplastic, UL 94V-0

Appliance-Inlet /-Outlet	C14/C18 acc. to IEC/EN 60320-1, UL 498, CSA C22.2 no. 42 (for cold condition) pin-temperature 70 °C, 10 A, Protection class I or II
Fuseholder	1 or 2 pole, Shocksafe category PC2 acc. to IEC 60127-6, for fuse-links 5 x 20 mm
Rated Power Acceptance @ Ta 23 °C	5 x 20: 1.6 W (1 pole)/ 1,2 W (2-pole) per pole
Power Acceptance @ Ta > 23 °C	Admissible power acceptance at higher ambient temperature see derating curves

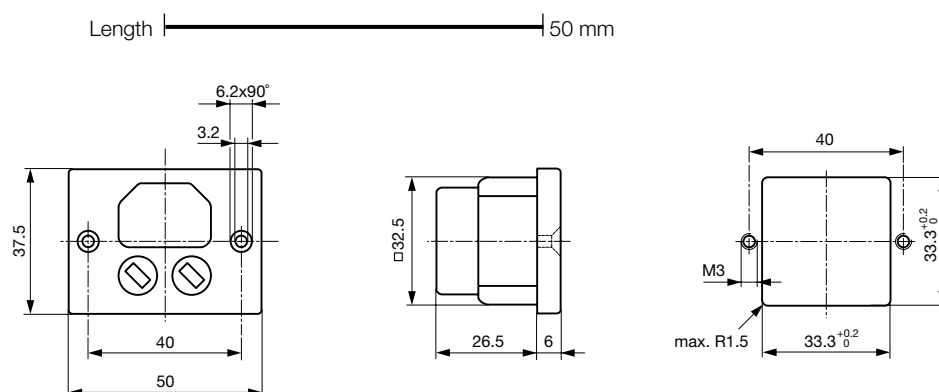
**Dimensions**

Diagrams

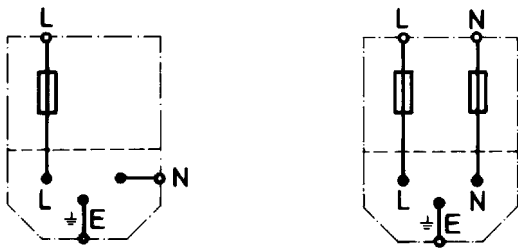

Derating Curves for Fuseholders

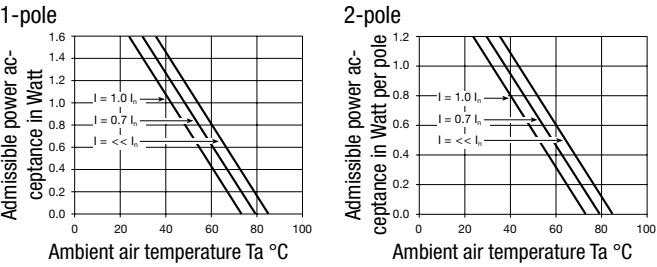

Variants

[Distributor-Stock-Check](#) | [SCHURTER-Stock-Check](#) | [e-Store](#)

Socket and fuse-carrier

Protection Class	Fuseholder	Case	Order Number
I	1 pole	black	0040.5012
I	2-pole	black	0040.5000.2
I	2-pole	Grey	0040.5001.2
II	2-pole	black	0040.5015

Packaging unit 100 Pcs