



Microwave Ceramics and Modules

Filter

2-Pol Filter for GPS

B69812N1577C403

Data Sheet

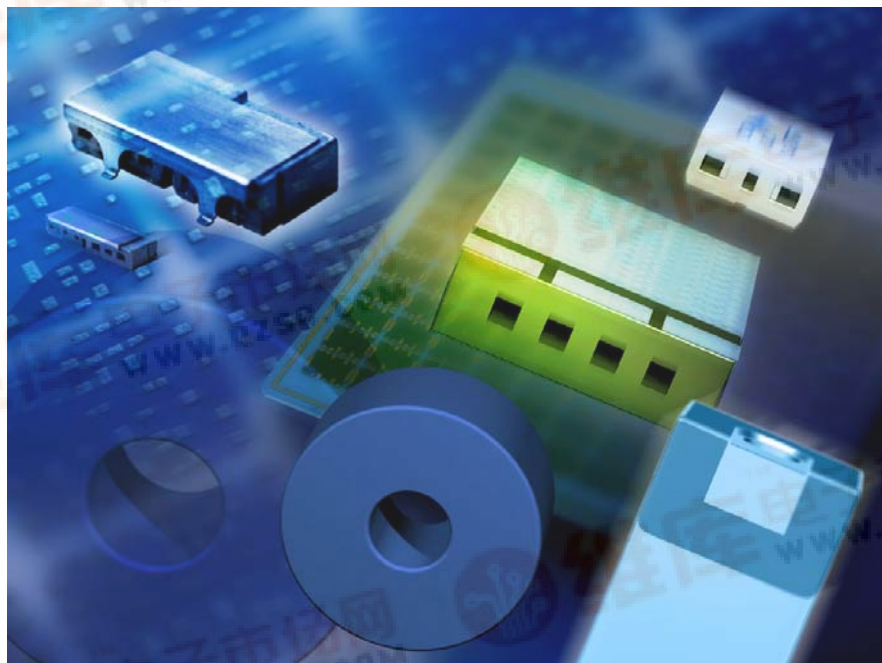

Features

- SMD filter consisting of coupled resonators with stepped impedances
- (NdBa)TiO₃ ($\epsilon_r = 88$ / $TC_f = 0 \pm 10$ ppm/K) with a coating of copper (10 μ m) and tin (>5 μ m)
- Excellent reflow solderability, no migration effect due to copper/tin metallization

Index

- | | |
|--------|---|
| Page 2 | <ul style="list-style-type: none"> ● Component drawing ● Recommended footprint |
| Page 3 | <ul style="list-style-type: none"> ● Characteristics ● Maximum ratings ● Typical passband characteristic |
| Page 4 | <ul style="list-style-type: none"> ● Processing information ● Soldering requirements ● Delivery mode |



Data Sheet

Component drawing

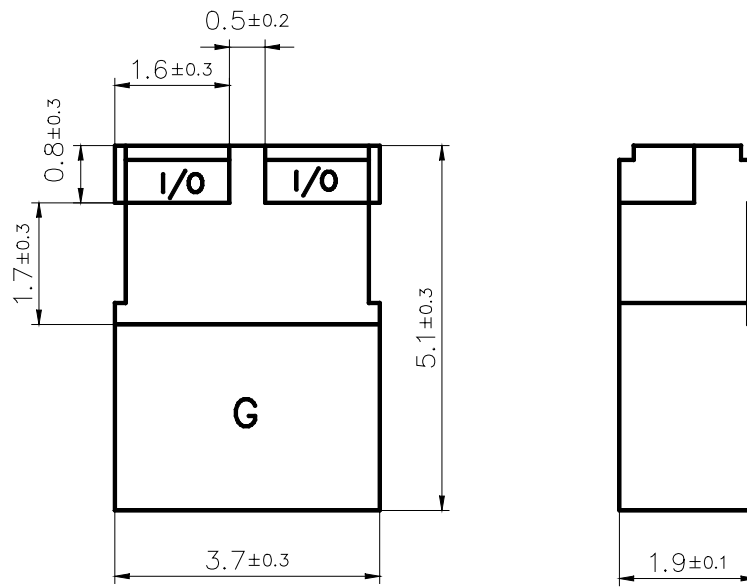

View from below onto the solder terminals and view from beside

Recommended footprint

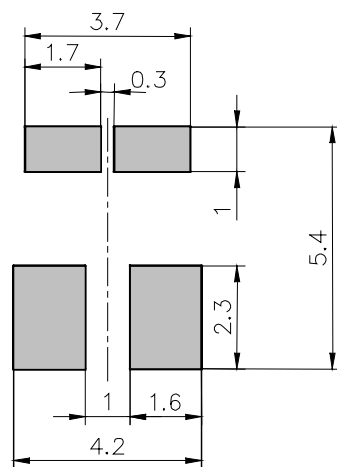



Microwave Ceramics and Modules

Filter

2-Pol Filter for GPS

B69812N1577C403

Data Sheet

Characteristics

		min.	typ.	max.	
Center frequency	f_C	-	1575	-	MHz
Insertion loss	α_{IL}		0.65	0.9	dB
Passband	B	3			MHz
Amplitude ripple (peak - peak)	$\Delta\alpha$			0.5	dB
Standing wave ratio	SWR		1.2	1.8	
Impedance	Z		50		Ω
Attenuation	α				
	at 900 MHz	20			dB
	at 1850 to 1990 MHz	20			dB

Maximum ratings

IEC climatic category (IEC 68-1)	T_{op}	- 40/+ 90/56	
Operating temperature		- 30/+ 85	°C

Typical Passband Characteristics

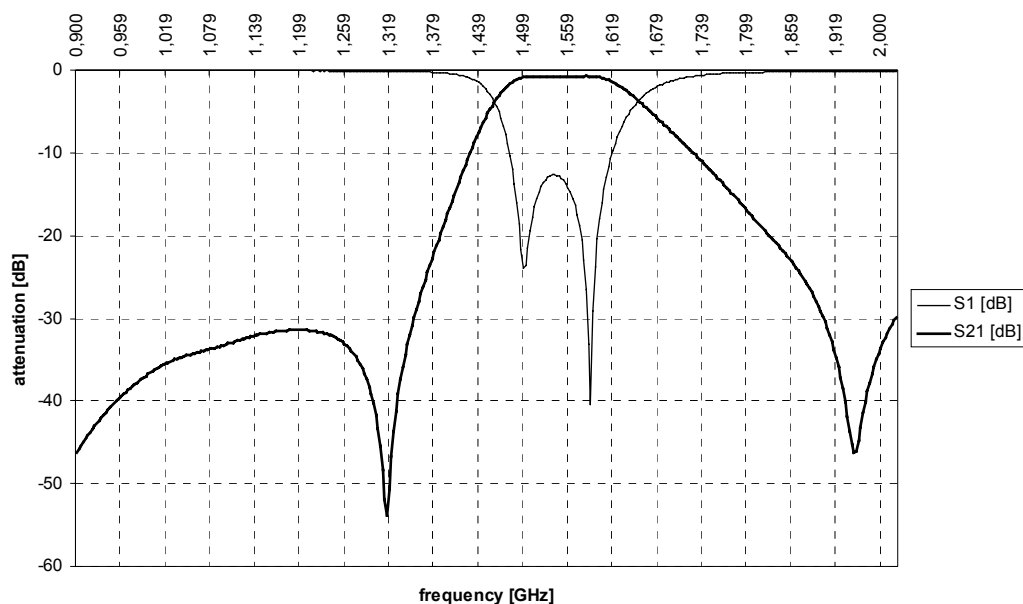

Data Sheet
Processing information

- Wettability acc. to IEC 68-2-58: $\geq 75\%$ (after aging)

Soldering Requirements

	Profile for eutectic SnPb solder paste	Profile for leadfree solder paste	
Soldering type	reflow	reflow	
Maximum soldering temperature (measuring point on top surface of the component)	235 (max. 2 sec.) 225 (max. 10 sec.)	260 (max. 2 sec.) 250 (max. 10 sec.)	°C °C

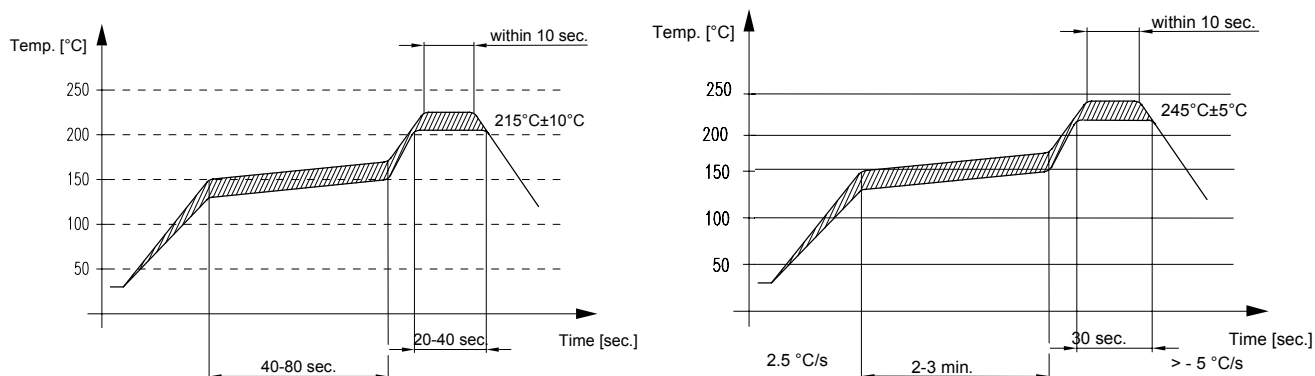
Recommended soldering conditions (infrared):

Delivery mode

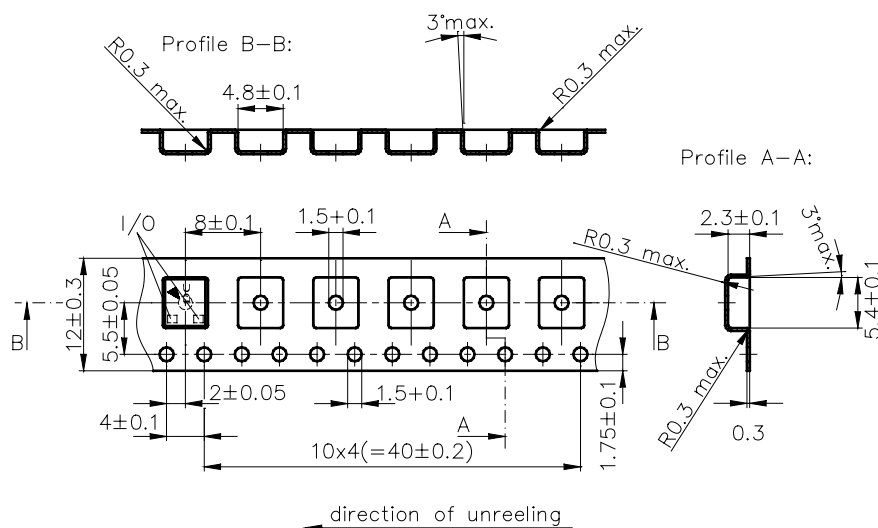
- Blister tape acc. to IEC 286-3, grey
- Pieces/tape: 3000



© EPCOS AG 2001. All Rights Reserved. Reproduction, publication and dissemination of this data sheet, enclosures hereto and the information contained therein without EPCOS' prior express consent is prohibited.

The information contained in this data sheet describes the type of component and shall not be considered as guaranteed characteristics. Purchase orders are subject to the General Conditions for the Supply of Products and Services of the Electrical and Electronics Industry recommended by the ZVEI (German Electrical and Electronic Manufacturers' Association), unless otherwise agreed.

ISSUE DATE	03.03.04	ISSUE	B	PUBLISHER	SAW MWC PD	PAGE	4/4
------------	----------	-------	---	-----------	------------	------	-----



中发网 WWW.ZFA.CN

全球最大的PDF中文下载站



中发网
www.zfa.cn

PDF 资料下载尽在中发网