

## Interface Portions and In-line Portions of the Various Units and Devices

# GT10 Series

— Subminiature ECU Interface Connectors —  
<2 mm Pitch>

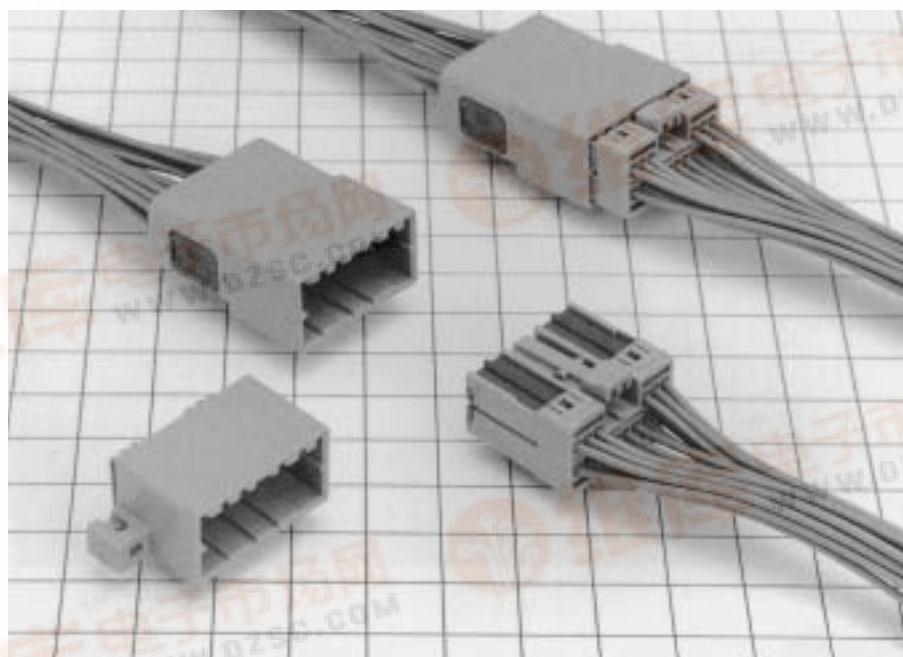

### Features

- Subminiature: with respect to existing 040 connectors.
- Front retainer design prevents incomplete insertion.

## F Connectors

### ● Center Terminals

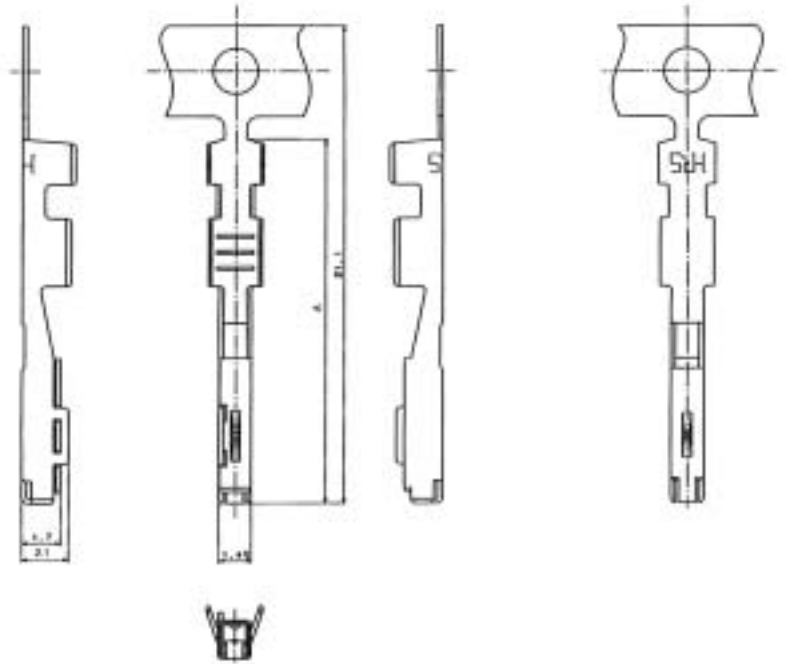

Part Number	CL No.	A	Conductor Size (AWG)	Outer Diameter	Material	Finish	Packaging
GT10-2022SCF	760-0003-0	16, 1	#20 to 22	1.1 to 1.3	Copper alloy	Tin plating	10,000 pcs. per reel
GT10-2428SCF	760-0009-6	15, 1	#24 to 28	0.8 to 1.1			

### ● Housing (with Retainer Provisionally Mounted)

#### ◆ Diagram of Retainer Fully Mounted

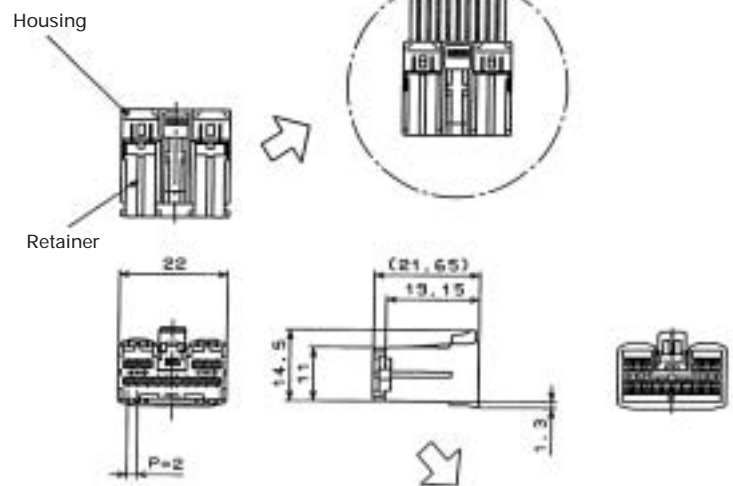

#### ◆ Diagram of Retainer Fully Mounted

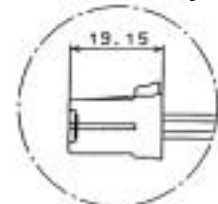

Part Number	CL NO.	Item	Material	Color
GT10-16DS-HU	760-0002-7	Housing	PBT	Light gray
		Retainer	PBT	Dark gray

Note: This product has the retainer provisionally mounted to the housing.  
To use, fully mount the retainer at the specified position after the terminals have been inserted.

## GT10S Series Type with Cover

### ● Housing

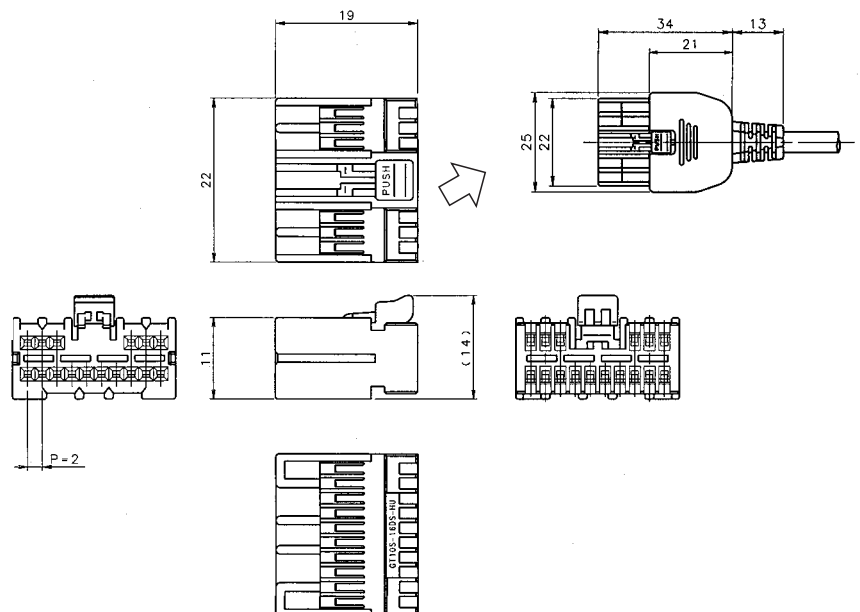

### ◆ View with Cover Attached

Part Number	CL No.	Material	Color
GT10S-16DS-HU	760-0007-0	PBT	Light gray

Note: This product should be used with the cover attached to the housing.

### ● Cover

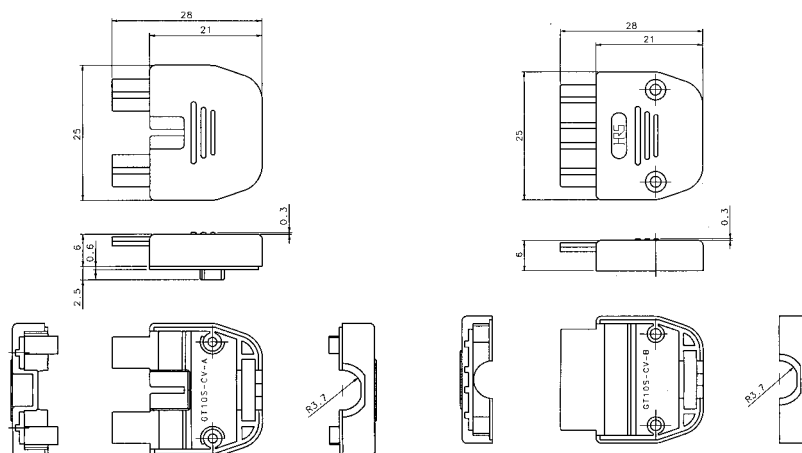

Cover A

Cover B

Part Number	CL No.	Material	Color
GT10S-16DS-CV	760-0008-3	PC	Black

Note 1: This product can be used with cables having outside diameters of 4, 4.8, and 5.2 mm.

Please use as a set in conjunction with clamp fittings and bushings that suit the cable.

Note 2: This product is sold as a set with cover A, B, and screws.

● Clamp Fittings



Part Number	CL No.	Material	A	Outer diameter of the cable
MQ138-CM (4.0)	206-0891-7	Brass	9	4.0
MQ138-CM (4.8)	206-0684-2		11.3	4.8
MQ138-CM (5.2)	206-0664-5		12	5.2

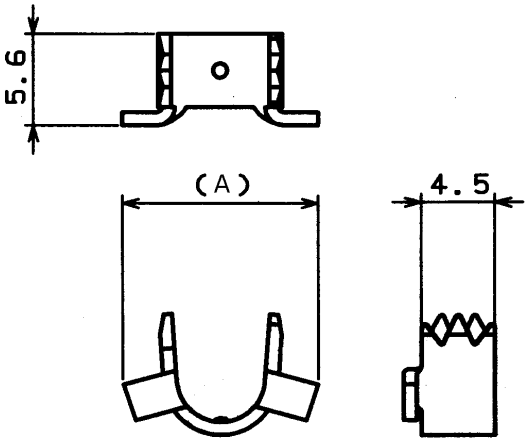

● Bushings



Part Number	CL No.	Material	Color	Outer diameter of the cable
MQ138-BS (4.0) (01)	206-0890-4-01	PCV	Black	4.0
MQ138-BS (4.8) (01)	206-0683-0-01			4.8
MQ138-BS (5.2) (01)	206-0662-0-01			5.2

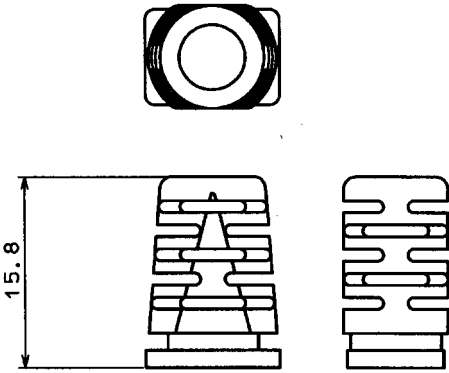

## M Connectors

### ● Terminals

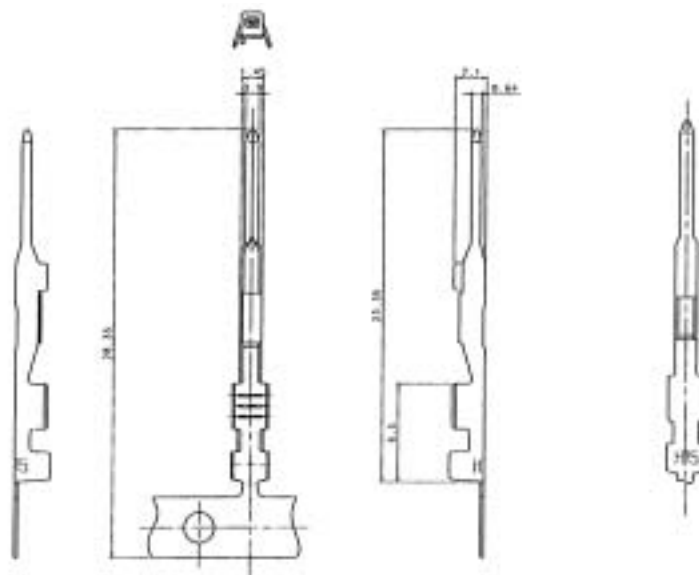

Part Number	CL No.	Material	Finish	Packaging
GT10-2022PCF	760-0006-8	Brass	Tin plating	10,000 pcs. per reel

### ● Housing



◆ Fully mated connector assemblies

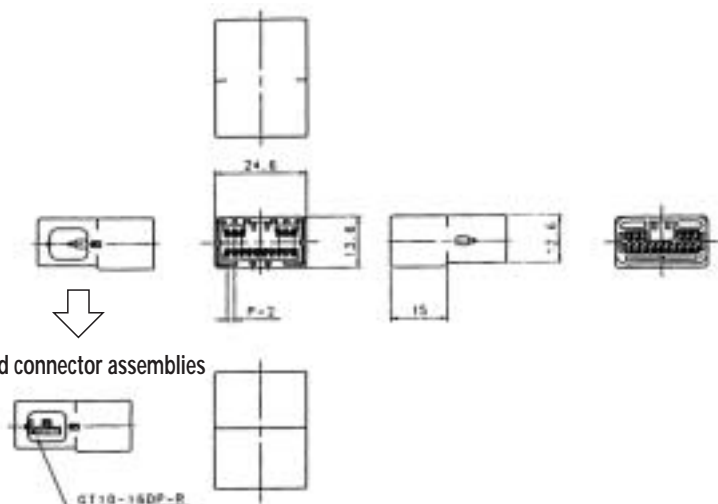

Part Number	CL No.	Material	Color
GT10-16DP-HU	760-0004-2	PBT	Light gray

### ● Retainer (Exclusively for GT10-16DP-HU)

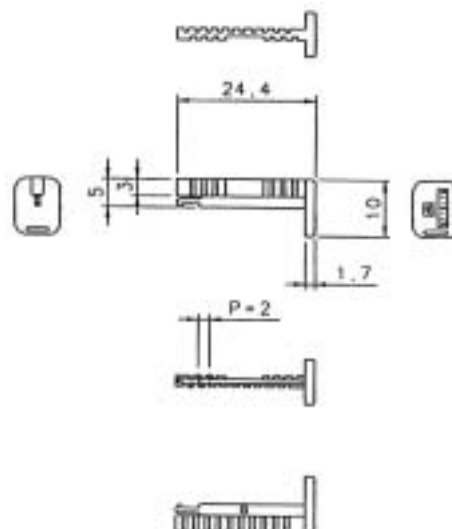

Part Number	CL No.	Material	Color
GT10-16DP-R	760-0005-5	PBT	Dark gray

● Board Type

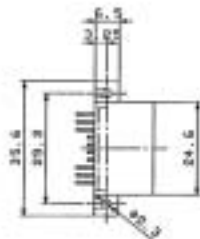

◆ Recommended Board Mounting Pattern

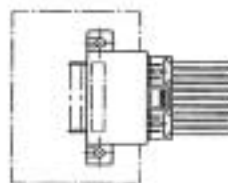
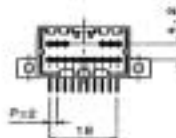
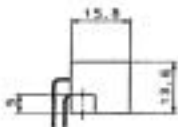
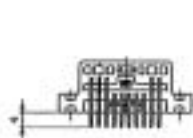
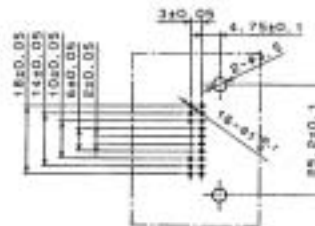

◆ Mounted and fully mated connector assemblies

Part Number	CL No.	Item	Material	Finish	Color
GT10-16DP-DS	760-0001-4	Housing	PBT	—	Light gray
		Terminal	Brass	Tin plating	—

Note: Use mounting screws of M3 with nominal diameter 3L-6 (for a board thickness of 1.6mm).

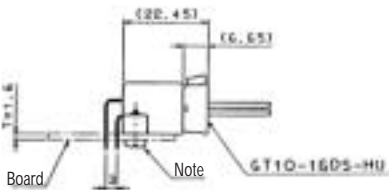

## GT10 Series Hybrid Type

### F Connectors

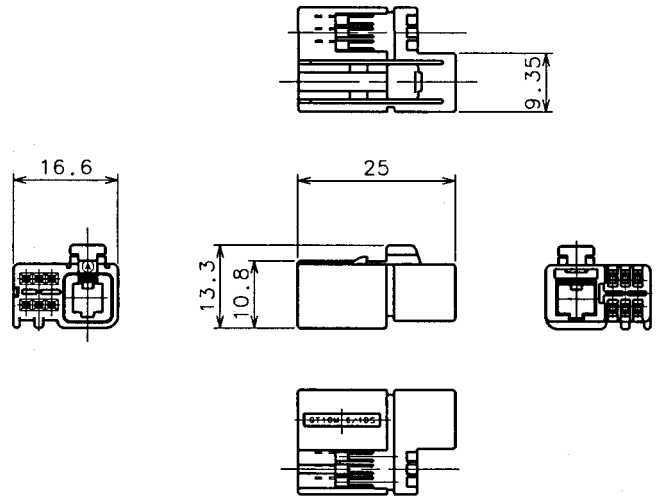

Part Number	CL No.	Material	Color
GT10M-6/1DS-HU	760-0010-5	PBT	Light gray

Note: Accepts GT5-30/0.7-1.5SCF terminals.

### ● Cover

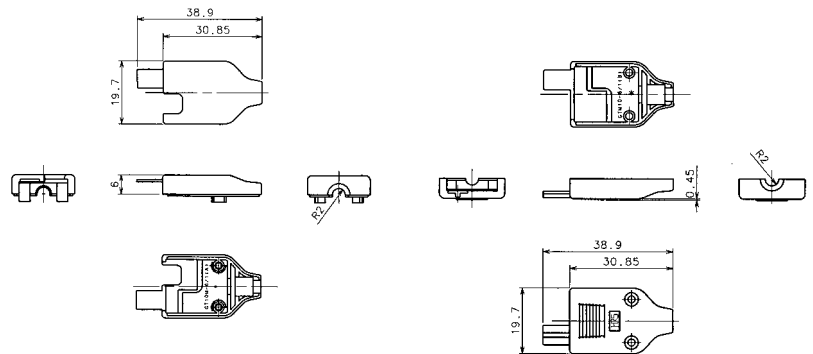

### ◆ Diagram of Retainer Fully Mounted

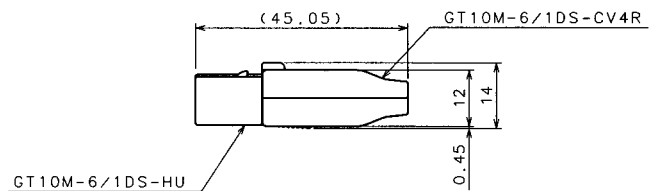

Part Number	CL No.	Material	Color
GT10M-6/1DS-CV4R	760-0012-0	PC	Black

This product is sold as a set of cover and screws.

### ● Clamp Fittings

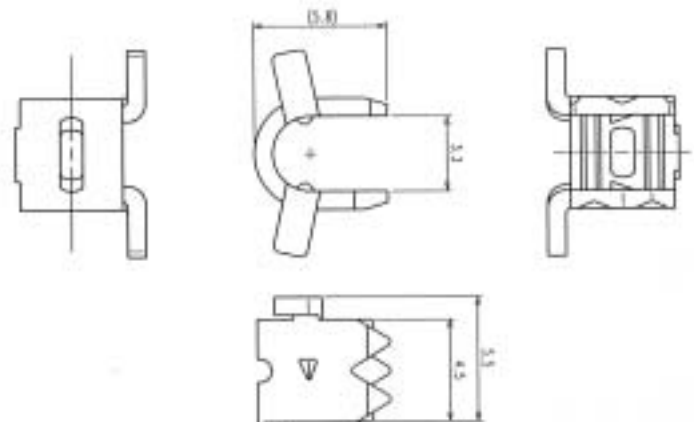

Part Number	CL No.
GT10M-CM (33)	760-0013-3

## ■ F Connectors

### ● Board Type

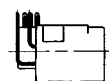
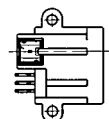
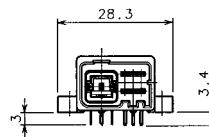
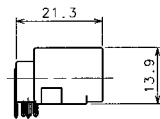
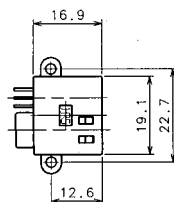
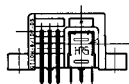

◆ Mounted and fully mated connector assemblies

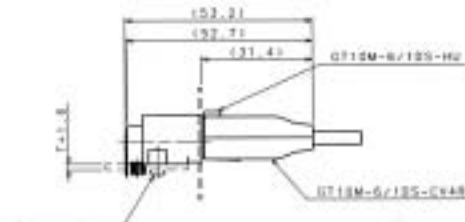

◆ Recommended Board Mounting Pattern ◆ Recommended Panel Cut-out

Part Number	CL No.	Item	Material	Finish	Color
GT10M-6/1DP-DS	760-0011-8		PBT		Light gray
			Brass	Tin plating	
			PBT		Light gray
			Brass	Tin plating	
			Phosphor bronze	Tin plating	

Note: Use mounting screws of M3 with nominal diameter 3L-6 (for a board thickness of 1.6mm).

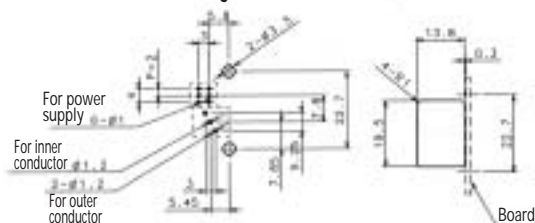

## Termination tools

User's manuals are available. Please contact your Hirose Electric account representative.

### ● Automatic Crimping Machine



Part Number CM-105

## Specifications

Item	Specification	Remarks
Specification	1.5tons	
Stroke Length	30mm	
Number of strokes	200spm (50Hz)	240spm (60Hz)
Weight	75kg	
Motor	0.2kw	AC100V
Crimping speed	2,000 to 4,000 pcs. per hour	