

SPECIFICATION FOR APPROVAL

查询"B43305B5397M067"供应商

PAGE: 1

PROD. NAME	RADIAL INDUCTOR	ABC'S DWG NO.	RB1010□□□□L□-□□□
		ABC'S ITEM NO.	

I . CONFIGURATION & DIMENSIONS :

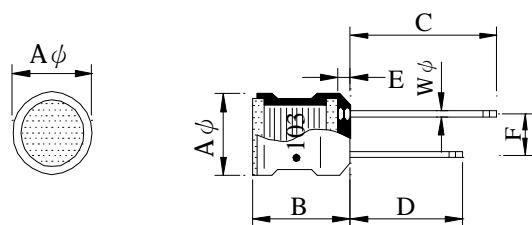

A	: 10.7±0.8	m/m
B	: 11.0±0.8	m/m
C	: 18.0±3.0	m/m
D	: 15.0±3.0	m/m
E	: 1.5 max.	m/m
F	: 7.0±0.8	m/m
$W\phi$: 0.80	m/m

Marking : " ● " : 103

II . SCHEMATIC DIAGRAM :



III . MATERIALS :

- a . Core : Ferrite DR core 10x10
- b . Wire : Enamelled copper wire (Class F)
- c . Lead : Sn/Ag/Cu
- d . Tube : Sheinkable tube 125°C , 600V
- e . Remark : Products comply with RoHS' requirements

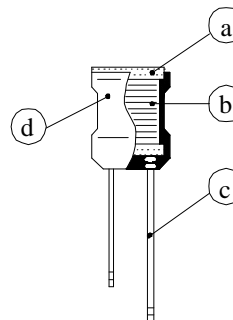

IV . ELECTRICAL CHARACTERISTICS :

- a . Temp. rise : 20°C max. at rated current.
- b . Storage temp. : -40°C---- +105°C
- c . Operating temp. : -25°C---- +85°C

AR-001A

SPECIFICATION FOR APPROVAL

查询"B43305B5397M067"供应商
REF: 20081011A

PAGE: 2

PROD. NAME	RADIAL INDUCTOR	ABC'S DWG NO.	RB1010□□□□L□-□□□
		ABC'S ITEM NO.	

V . ELECTRICAL CHARACTERISTICS :

DWG No.	Inductance (uH)	Q min.	Test Freq. (Hz)		SRF (MHz) min.	RDC (Ω) max.	IDC (mA) max.
			L	Q			
RB1010101□L□-□□□	100 ± 10%	30	1V/1K	0.796M	3.500	0.12	900
RB1010121□L□-□□□	120 ± 10%	40	1V/1K	0.796M	3.000	0.18	820
RB1010151□L□-□□□	150 ± 10%	35	1V/1K	0.796M	2.800	0.20	780
RB1010181□L□-□□□	180 ± 10%	30	1V/1K	0.796M	2.600	0.23	680
RB1010221□L□-□□□	220 ± 10%	30	1V/1K	0.796M	2.200	0.28	620
RB1010271□L□-□□□	270 ± 10%	28	1V/1K	0.796M	2.000	0.32	520
RB1010331□L□-□□□	330 ± 10%	22	1V/1K	0.796M	1.800	0.38	480
RB1010391□L□-□□□	390 ± 10%	20	1V/1K	0.796M	1.700	0.43	430
RB1010471□L□-□□□	470 ± 10%	17	1V/1K	0.796M	1.600	0.50	400
RB1010561□L□-□□□	560 ± 5%	18	1V/1K	0.796M	1.500	0.65	370
RB1010681□L□-□□□	680 ± 5%	15	1V/1K	0.796M	1.300	0.80	330
RB1010821□L□-□□□	820 ± 5%	18	1V/1K	0.796M	1.220	1.00	300
RB1010102□L□-□□□	1000 ± 5%	15	1V/1K	0.252M	1.100	1.20	270
RB1010122□L□-□□□	1200 ± 5%	13	1V/1K	0.252M	1.000	1.30	250
RB1010152□L□-□□□	1500 ± 5%	35	1V/1K	0.252M	0.820	1.80	220
RB1010182□L□-□□□	1800 ± 5%	30	1V/1K	0.252M	0.780	2.20	200
RB1010222□L□-□□□	2200 ± 5%	40	1V/1K	0.252M	0.720	2.80	180
RB1010272□L□-□□□	2700 ± 5%	35	1V/1K	0.252M	0.680	3.20	160
RB1010332□L□-□□□	3300 ± 5%	30	1V/1K	0.252M	0.660	3.60	155
RB1010392□L□-□□□	3900 ± 5%	30	1V/1K	0.252M	0.600	4.20	140
RB1010472□L□-□□□	4700 ± 5%	25	1V/1K	0.252M	0.480	5.40	130
RB1010562□L□-□□□	5600 ± 5%	25	1V/1K	0.252M	0.450	6.00	120
RB1010682□L□-□□□	6800 ± 5%	25	1V/1K	0.252M	0.380	7.50	110
RB1010822□L□-□□□	8200 ± 5%	25	1V/1K	0.252M	0.350	8.60	105
RB1010103□L□-□□□	10000 ± 5%	50	1V/1K	79.6K	0.340	10.00	100
RB1010123□L□-□□□	12000 ± 5%	45	1V/1K	79.6K	0.300	13.50	80
RB1010153□L□-□□□	15000 ± 5%	50	1V/1K	79.6K	0.280	17.00	70
RB1010183□L□-□□□	18000 ± 5%	45	1V/1K	79.6K	0.230	21.00	55
RB1010223□L□-□□□	22000 ± 5%	55	1V/1K	79.6K	0.200	25.00	52
RB1010273□L□-□□□	27000 ± 5%	50	1V/1K	79.6K	0.190	32.00	48
RB1010333□L□-□□□	33000 ± 5%	45	1V/1K	79.6K	0.180	40.00	40
RB1010393□L□-□□□	39000 ± 5%	40	1V/1K	79.6K	0.160	45.00	37
RB1010473□L□-□□□	47000 ± 5%	40	1V/1K	79.6K	0.150	52.00	32
RB1010563□L□-□□□	56000 ± 5%	35	1V/1K	79.6K	0.130	66.00	30
RB1010683□L□-□□□	68000 ± 5%	35	1V/1K	79.6K	0.125	78.00	24
RB1010823□L□-□□□	82000 ± 5%	35	1V/1K	79.6K	0.120	105.00	22
RB1010104□L□-□□□	100000 ± 5%	30	1V/1K	25.2K	0.100	140.00	20

1). □ : Packaging information... Bulk

2). "- □□□":Reference code

AR-001A



SPECIFICATION FOR APPROVAL

查詢"B43305B5397M067"供應商

PROD. NAME	RADIAL INDUCTOR	ABC'S DWG NO.	RB1010□□□□L□-□□□
		ABC'S ITEM NO.	

VI . DWGING NUMBER EXPRESSION :

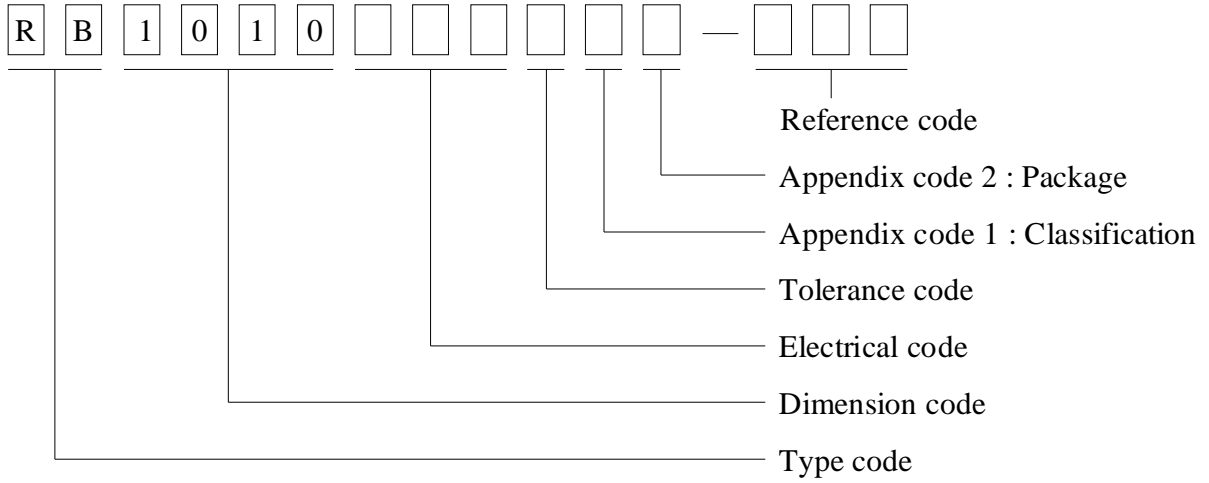

Appendix code 1 : Product Classification

- L : Lead Free Standard products comply with RoHS' requirements
- 1 ~ 9 : Lead Free Special products comply with RoHS' requirements

Appendix code 2 : Package Information

Code	Inner package	Inner package Q'TY	Remark
A	Box	145 pcs	

