

TR5® / No. 382
[查询"3821125000"供应商](#)

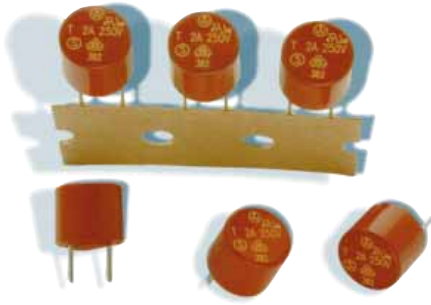

Dimensions (mm)

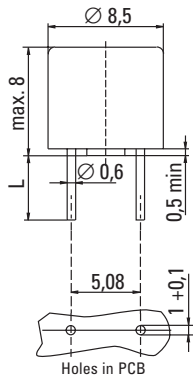

Long Leads (L=18.8mm)
 Short Leads (L=4.3mm)

IEC 60127-3/IV, 250V, T

Time-Current Characteristic

Time Lag (T)

Standard

IEC 60127-3/IV

Approvals

VDE: License No. 122750
 SEMKO: Certificate No. 9937118
 cULus Recognized: File No. E 67006
 MITI: File No. 32-1926

Features

- Enhanced breaking capacity
- Reduced PCB space requirements
- Direct solderable or plug-in versions
- Internationally approved
- Low internal resistance
- Shocksafe casing
- Vibration resistant

WebLinks

Data Sheet

www.wickmann.com/products/382.pdf

Approval Certificates

www.wickmann.com/approvals

Time-Current Curve

Page 59
www.wickmann.com/itcurves

Packaging

Page 118
www.wickmann.com/pack

FaxBack Document # 300

Specifications

Packaging

000: Tape/Ampopack (1000 pcs.)
 041: Short Leads - Bulk (1000 pcs.)

Materials

Base/Cap: Brown Thermoplastic
 Polyamide PA 6.6, UL 94V0
 Round Pins: Copper alloy, tin plated

Operating Temperature

-40°C to +85°C (consider de-rating)

Climatic Category

-25°C/+70°C/21 days (IEC 60068-2-1..3)

Stock Conditions

+10°C to +60°C
 relative humidity ≤ 75% yearly average,
 without dew, maximum value for 30 days-95%

Vibration Resistance

24 cycles at 15 min. each (IEC 60068-2-6)
 10 - 60Hz at 0.75mm amplitude
 60 - 2000Hz at 10g acceleration

Lead Pull Strength

10N (IEC 60068-2-21)

Solderability

260°C, ≤ 3 sec. (Wave)
 350°C, ≤ 1 sec. (Hand)

Soldering Heat Resistance

260°C, 10 sec. (IEC 60068-2-20)

Marking

 , 382, 250V, T, Current Rating, Approvals

Unit Weight

0.82g (approx.)

| Limits for Pre-arcing Time | | | | | |
|----------------------------|--------------------------|--------------------------|---------------------------|------------------------|-------------------------|
| Rated Current | 1.5 x I _{Rated} | 2.1 x I _{Rated} | 2.75 x I _{Rated} | 4 x I _{Rated} | 10 x I _{Rated} |
| 1.00A ... 5.00A | > 1h | < 2 min | 400ms ... 10s | 150ms ... 3s | 20ms ... 150ms |



| Permissible continuous operating current is ≤ 100% at ambient temperature of 23°C (73.4°F). | | | | | | | | | | |
|---|----------|----------------|--------------------------|---|--|---|-----------|-------|-------|------|
| Rated Current | Amp Code | Voltage Rating | Breaking Capacity | Voltage Drop 1.0 x I _{Rated} max. (mV) | Power Dissipation 1.5 x I _{Rated} max. (mW) | Melting Integral 10 x I _{Rated} min. (A²s) | Approvals | | | |
| | | | | | | | VDE | SEMKO | cULus | MITI |
| 1.00A | 1100 | 250V | | 100 | 400 | 3.0 | • | • | • | • |
| 1.25A | 1125 | 250V | | 95 | 465 | 4.5 | • | • | • | • |
| 1.60A | 1160 | 250V | | 90 | 490 | 9.0 | • | • | • | • |
| 2.00A | 1200 | 250V | 100A/250VAC ¹ | 85 | 670 | 12 | • | • | • | • |
| 2.50A | 1250 | 250V | 50-60Hz | 80 | 750 | 22 | • | • | • | • |
| 3.15A | 1315 | 250V | cos φ = 1.0 | 75 | 900 | 32 | • | • | • | • |
| 4.00A | 1400 | 250V | | 70 | 1200 | 58 | • | • | • | • |
| 5.00A | 1500 | 250V | | 65 | 1250 | 90 | G | G | • | • |

¹ Breaking capacity ratings per approval agencies:
 VDE: 35 A or 10 x I_{Rated} at 250V, whichever is greater.
 100 A at 250V; Expert Report
 SEMKO: 35 A or 10 x I_{Rated} at 250V, whichever is greater.
 UL: 50 A at 250V
 MITI: 100A at 250V

^G Expert Report

Order Information

| Qty. | Order-Number | Series | Amp Code | Packaging |
|------|--------------|--------|----------|-----------|
| | | 382 | | |

[查询"3821125000"供应商](#)

TR5[®] / No. 382

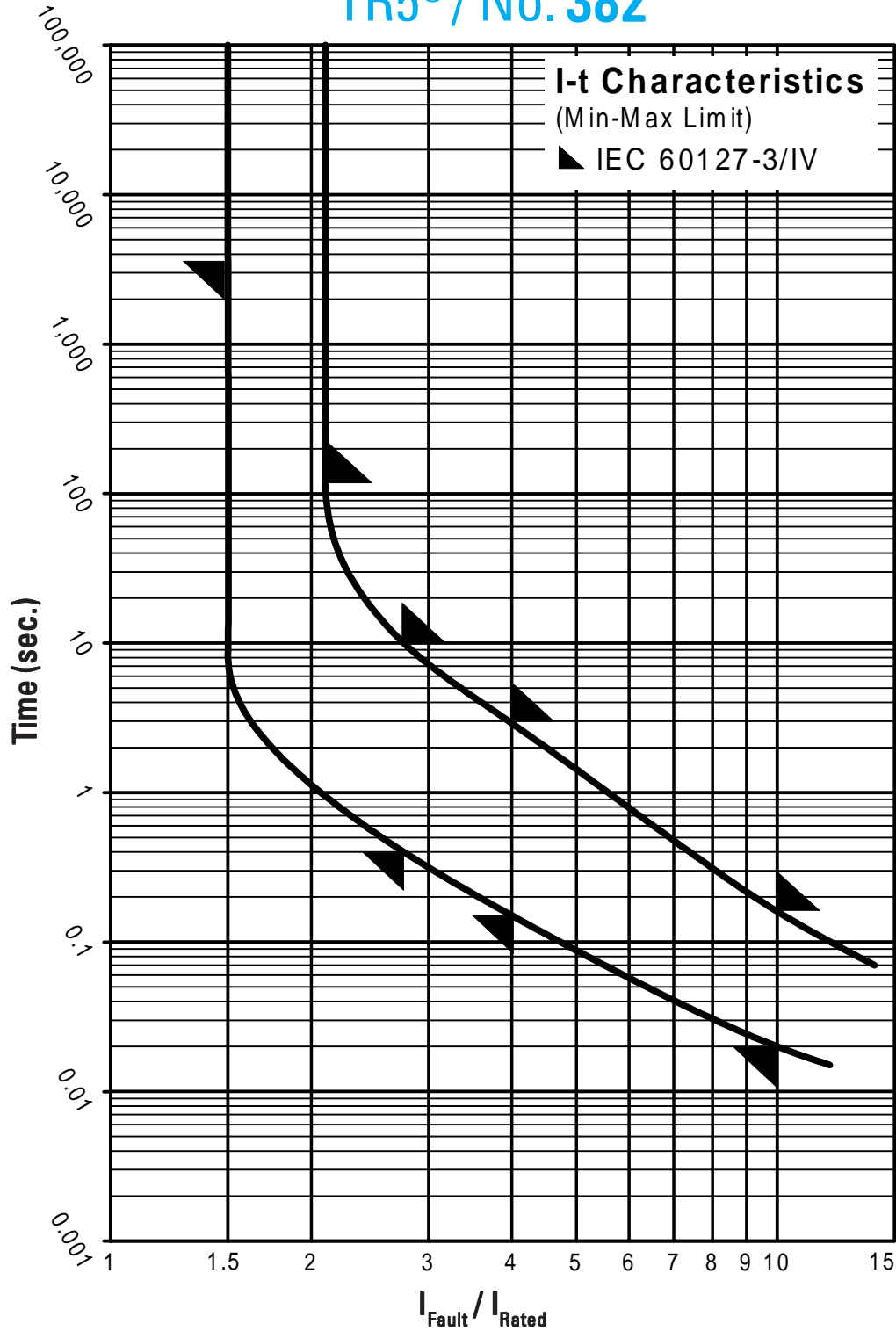

Contact WICKMANN for individual I-t curves