

Speakon®

Loudspeaker Amplifier Connectors

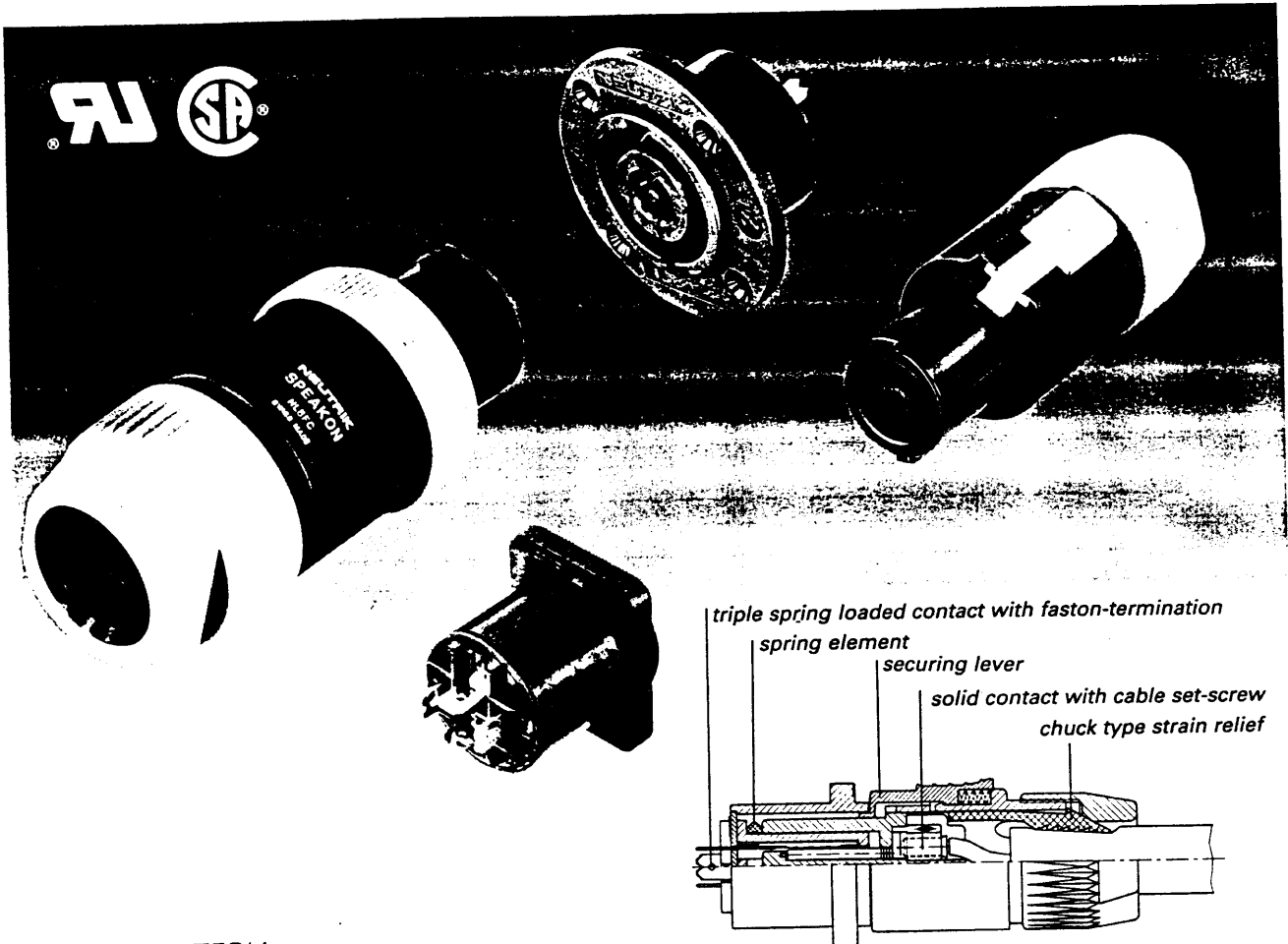

DESIGN CRITERIA

- 4-pole version now available with new quicklock system: much easier handling of the release mechanism with a locking lever.
- Only 2 variations of the connector in 4-pole and 8-pole configuration for simplicity: cable version and a chassis-mount type
- All contacts on both connectors are touch proof, the connector meets the safety requirements of IEC 65, IEC 348, UL Recognized, CSA listed
- Terminations are solderless, making the connectors field serviceable, and the chassis types are fast and reliable to wire with Faston-terminations.
- Chassis connector for speakers is airtight and uses panel cutouts the same as existing audio connector types for flexibility and simplicity of metal/wood work tooling.
- Extremely robust, step-on proof, multiple contact finger for highest connecting integrity.
- Contacts are designed to prevent any damage (arcing) when disconnected under load.



NEUTRIK

CONNECTING THE WORLD

CONNECTORS
AUDIO TEST SYSTEMS
INFOMATIC SYSTEMS

Dimensional Drawings

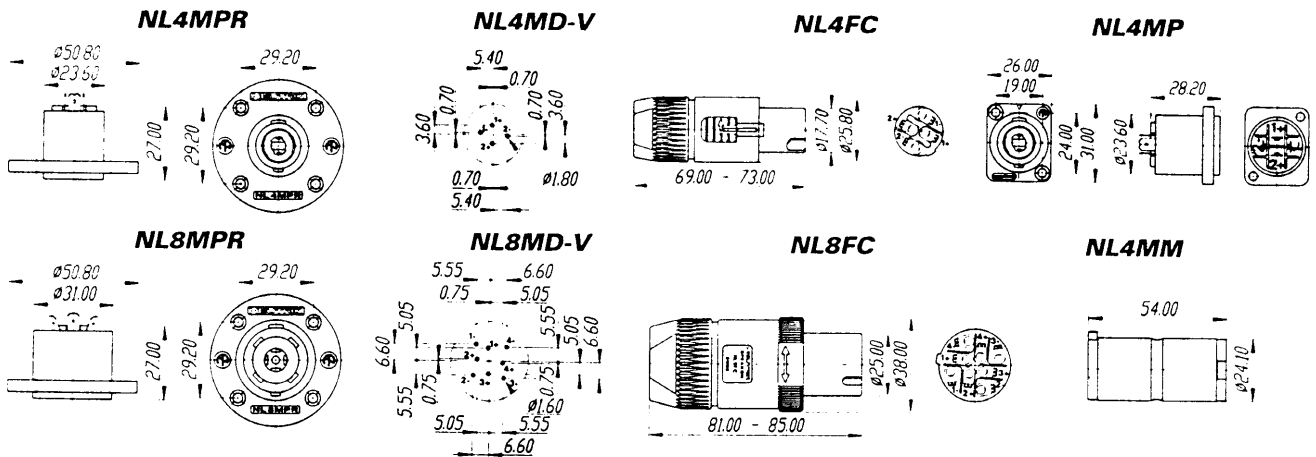

Specification and Technical Data

MATERIALS

Contact: Zn Al4 Cu1/Cu Sn8
4 μm Ag plated
Securing lever: Zn Al4 Cu1, Cu Ni plated
Spring element: Neoprene ring
Housing: PA 6.6 30% GR
Bushing: PA 6.6 15% GR
Chuck: POM

MECHANICAL

Retention method: Locking with securing lever (4-pole) or securing ring (8-pole)
Cable anchoring: NEUTRIK chuck principle
Cable OD range: 6 – 15 mm (4-pole), 8 – 20 mm (8-pole)
Wiring:
• Cable: screws with protection cups or soldering.
• Chassis: Faston 0.187" x 0.02" (4.8 mm x 0.5 mm) or PCB-versions: pin dimension: 1.6 mm x 0.5 mm
Max. wire size/contact: 6 mm² (solid), 10 AWG; 4 mm² (stranded), 12 AWG
Cable retention force: ≥ 220 N, depending on cable dia and material
Operating temperature: -30°C to +80°C

ELECTRICAL

UL-, CSA-listed
Rated current/contact: 30 A rms continuous, 40 A rms 1 min.
Test voltage: 4240 Vpp
Rated voltage: 250 Vac
Contact resistance: ≤ 3 mΩ after 5000 insertions
Insulation resistance: after saltmist test IEC 68-2-11: > 10⁸ Ω
Inrush/outrush current capability (12 V source): 300/30 A/200 ms
Creepage distance: according to IEC 664-1

Wiring

Positive signal on speaker pin "+" produces positive waveform from driver (moves cone outwardly)
"+" = In phase (high) "-" = Ground (out of phase low) Lower numbers for lower frequencies

	AMPLIFIER	CABLE	SPEAKER
Stereo ("HiFi")	one NL4MP socket left channel pins 1+/1- right channel pins 2+/2-	NL4FC on amplifier end, four conductor cable splits into two pairs with NL4FC on each end.	one NL4MP per speaker left speaker pins 1+/1- right speaker pins 2+/2-
Power ("PA") Standard	three NL4MP sockets "A" socket: left channel pins 1+/1- "B" socket: right channel pins 1+/1- "M" socket: left channel pins 1+/1- right channel pins 2+/2-	a two-conductor cable for each channel with NL4FC on both ends	NL4MP pin 1+ to speaker coil "+", NL4MP pins 1- and 2+ to speaker coil "-"
Bridged mono	"M" socket: left channel pins 1+/1- right channel pins 2+/2-	a special two-conductor cable, on both ends wired to pins 1+/2+ of NL4FC.	NL4MP pin 1+ to speaker coil "+", NL4MP pins 1- and 2+ to speaker coil "-"
Bi - Amp	one NL4MP socket low frequency pins 1+/1- high frequency pins 2+/2-	a four-conductor cable on both ends wired to pins 1+/1- 2+/2- of NL4FC	one NL4MP socket low frequency pins 1+/1- high frequency pins 2+/2-

Ordering Information

- Cable connector, quick lock with securing lever
- Cable connector, twist lock with securing ring
- Chassis connector, air tight
Neutrik D- and G-series compatible
- Direct on PCB-version, air tight
- Chassis connector, air tight, round flange,
Cannon EP 13/14 compatible
- Coupler for linking (extending) cables

4-pole	8-pole
NL4FC	NL8FC
NL4MP	NL8MP
NL4MD-V	NL8MD-V
NL4MPR	NL8MPR
NL4MM	NL8MM



NEUTRIK

CONNECTING THE WORLD

REPRESENTED AND SERVICED BY:

NEUTRIK AG
Liechtenstein
Tel 075 / 237 24 24
Fax 075 / 232 53 93

NEUTRIK USA INC.,
USA
Tel 908 / 901 9488
Fax 908 / 901 9608

NEUTRIK UK Ltd.
United Kingdom
Tel 0983 / 81 14 41
Fax 0983 / 81 14 39

NEUTRIK Zürich AG
Switzerland
Tel 01 / 734 0400
Fax 01 / 734 3891

Datas subject to change without prior notice

SPE/E - 1/95

Dimensional Drawings

NL4MPR

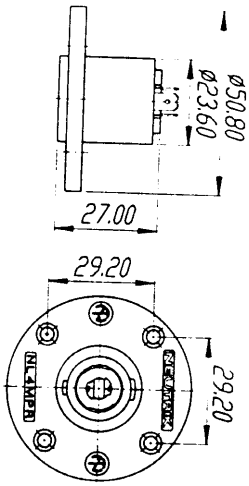

NL8MPR

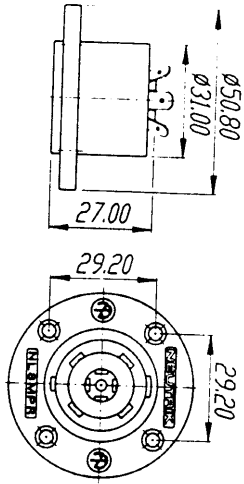

NL4MD-V

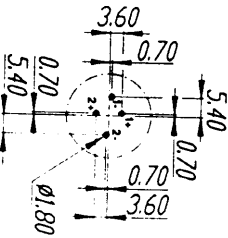

NL8MD-V

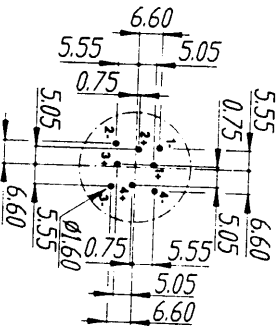

NL4FC

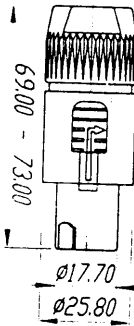

NL8FC

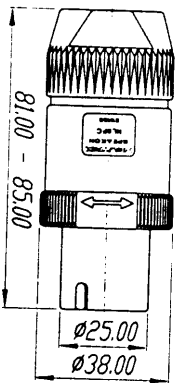

NL4MP

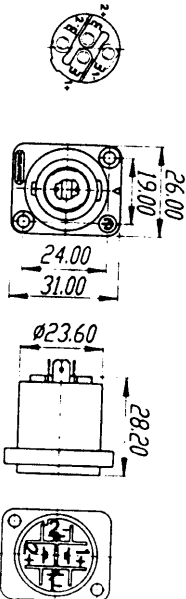

NL4MM

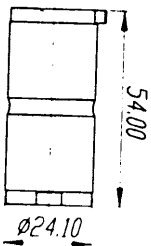

Specification and Technical Data

MATERIALS

Contact: Zn Al4 Cu1/Cu Sn8
 4 μm Ag plated
Securing lever: Zn Al4 Cu1, Cu Ni plated

MECHANICAL

Retention method: Locking with securing lever (4-pole) or securing ring (8-pole)
Cable anchoring: NEUTRIK chuck principle

ELECTRICAL

UL-, CSA-listed
Rated current/contact: 30 A rms continuous, 40 A rms 1 min.
Test voltage: 4240 V_{pn}